

# DS04 User Guide

Intelligent Glass Door Lock

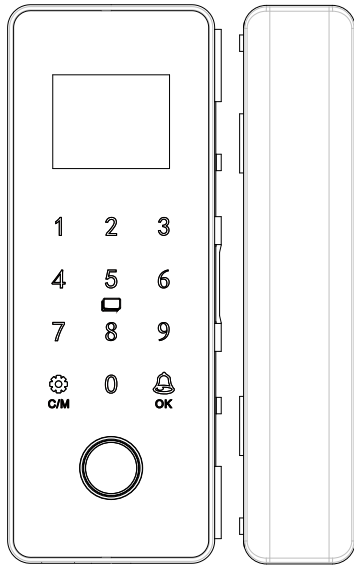

Enjoy High Technology Office

## How to adjust the direction

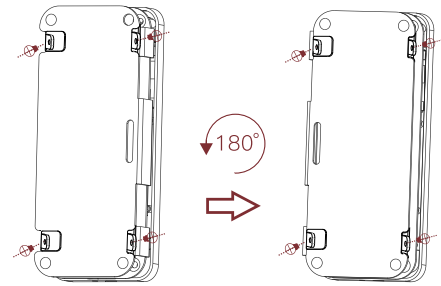

1. Unfasten the screws on both sides of the main lock and take off the rear housing. Then unfasten the four fixing screws on the front housing.
2. Separate the U-shaped bracket and the front housing, then install the bracket back after rotating it 180 degrees.
3. Install the rear housing after rotating it 180 degrees as well.

## Assemble and disassemble cables

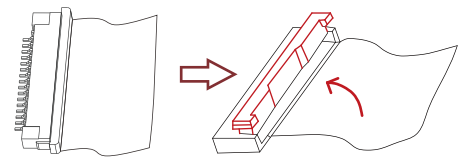

1. When detaching the cable, gently pull out the cable lock with both fingers, and then pull out the cable. Please remember the top and bottom side of the cable for the next step.
2. When installing the cable, insert the cable correctly first, and then push back the cable lock.

**Note:** Please gently pull and push the cable lock to avoid damage.

## Installation: Frameless glass door

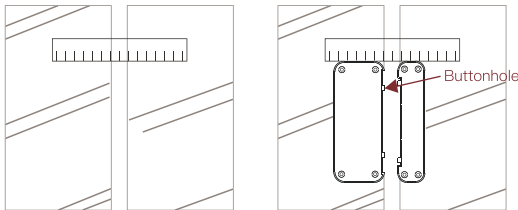

- 1 Clean the glass and stick the horizontal positioning card inside the door.
- 2 Tear off the mounting plate tape and attach it to the card position.

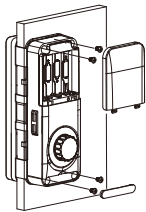

- 3 Install the main lock rear housing, and fasten 4 fixing screws. (The secondary lock has the same operation)

### Note

1. Be sure to use a horizontal positioning plate to align the main and secondary locks, and the gap between 2 glass should not be less than 4mm.
2. Suitable for glass door thickness 10 - 12mm.

## Installation: Single glass door

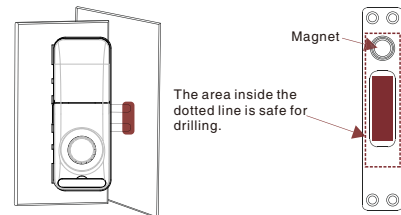

- 1 Install the main lock using the same method with last page, and mark the correct bolt position after closing the door.
- 2 Drill the holes on the wall and then install the side plate. Note that the magnet orientation should be consistent with the main lock knob (this figure shows it's on the top).

## Installation: Framed glass door

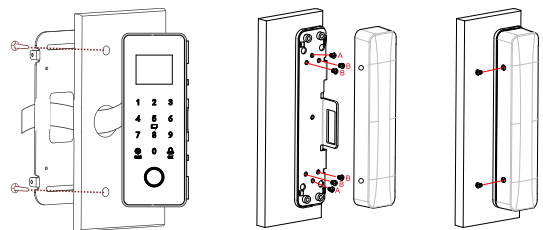

- 1 Drill holes according to the size and position of the main lock, and then put the screws and cable through the front plate. Fasten the screws to fix the front panel and then install the rear housing.
- 2 Fix the metal plate of the secondary lock using tapping screw A or rivet B, and then install the rear housing. Note that the secondary lock only has rear housing.

## Function diagram

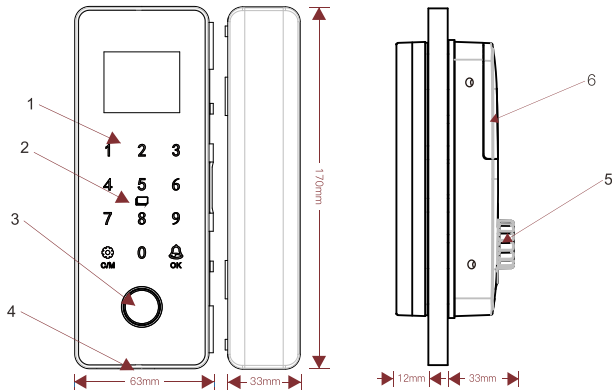

1. Keyboard
2. Card reading area
3. Fingerprint sensor
4. USB power port
5. Battery compartment
6. Knob

## Scramble PIN code

Anti-peeping password recognition system. Supports up to 16 digits virtual password(real password 6 - 8 digits). For example, if the actual password is 88888, then you can enter "123458888854321" and press OK to open the door.

## Normal open mode

By default this function is disabled. If you need to turn it on, just open the door and then press "9" and OK to activate it(auto-locking function is disabled now). You can press "0" and OK to disable it again(auto-locking function is enabled now).

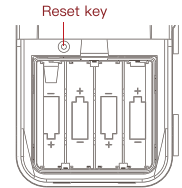

Schematic diagram of battery box

## Reset the lock

As is shown in the figure on the right, open the battery cover and press the reset key with a pin for more than 5 seconds.

## Technical parameter

**Unlocking mode:** Fingerprint / password / card and other methods  
**Sensor type:** Semi-conductor fingerprint sensor  
**Recognition speed:** <0.5s  
**Failure rate:** <0.0001%  
**Fingerprint capacity:** 100  
**User capacity:** 1000  
**Remote control capacity:** 36(optional)  
**Working temperature:** -25°C ~ 65°C  
**Working humidity:** 5 ~ 95%(no condensation)  
**Power supply:** 1.5V AA alkaline batteries x4  
**Emergency power supply:** MicroUSB  
**Current:** Static <50uA, dynamic <200mA  
**Application:** 8 - 12mm frameless glass door(door gap 4 - 15mm)  
 30 - 120mm framed glass door / wooden door

## Quick guide

1. By default it is experience mode, and any fingerprint, password or card can unlock the door. Long press "CM" button to enter the menu.
2. Please add administrators first(max. 3 administrators).
3. After the door is open, press "9" and OK to activate the normal open mode, and press "0" and OK to disable the normal open mode.
4. Press the reset button for 5 seconds and then there is a voice prompt "Initialize the system". After this the lock is initialized.

## SMARTLIFE Smart APP



Please download "SmartLife" APP from APP Store on iOS or Android devices. After installation, please register yourself with your mobile phone number.

### 1. Add device

- 1) Set the lock to WIFI configuration mode in Menu -> System Set -> Network Config:
  - a. Turn on WIFI.
  - b. Select "WIFI Config".
- 2) From the home page of SmartLife APP select "Add Device" and the APP will find the lock. Choose the right device to add.
- 3) Select 2.4G WIFI network and input password, then press "Next".

**NOTE :** SmartLife does not support 5GHz WIFI, please use 2.4GHz WIFI only.

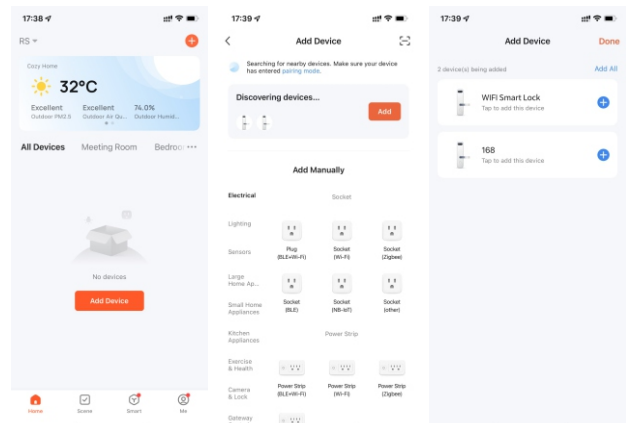

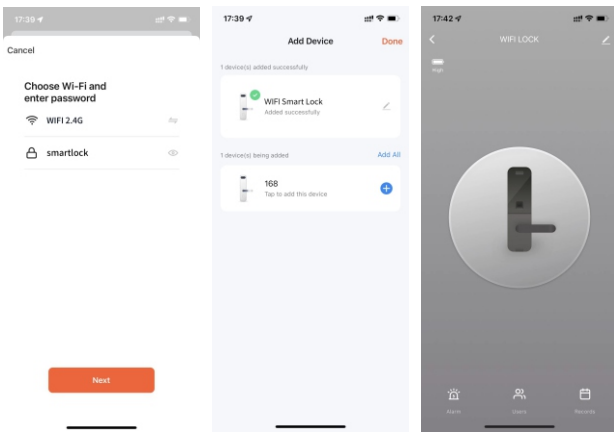

## 2. Remote unlock

When someone presses the doorbell button on the lock, SmartLife APP will receive a message. Press this message and there will be a popup dialog, select "Confirm" and the door can be opened remotely. You may see the remote opening record in the APP.

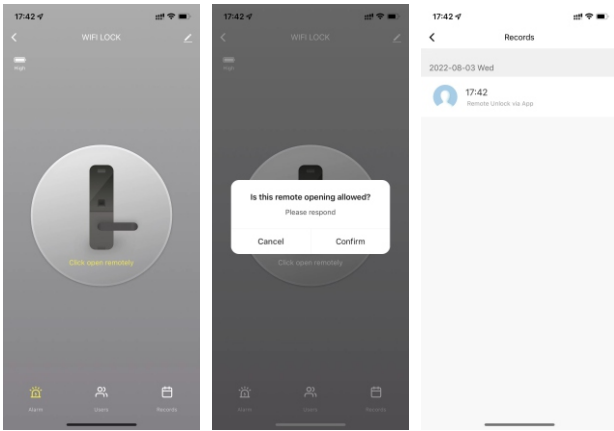

## 3. Member management

You can add member from the member management page, and add fingerprint, password or card information to each member. For example, Tom has registered his fingerprint, password and card in the device with ID 1, and then we can add them to the APP(all of them use the same ID 1). When next time he opens the door, the APP will receive a message with the unlocking details.

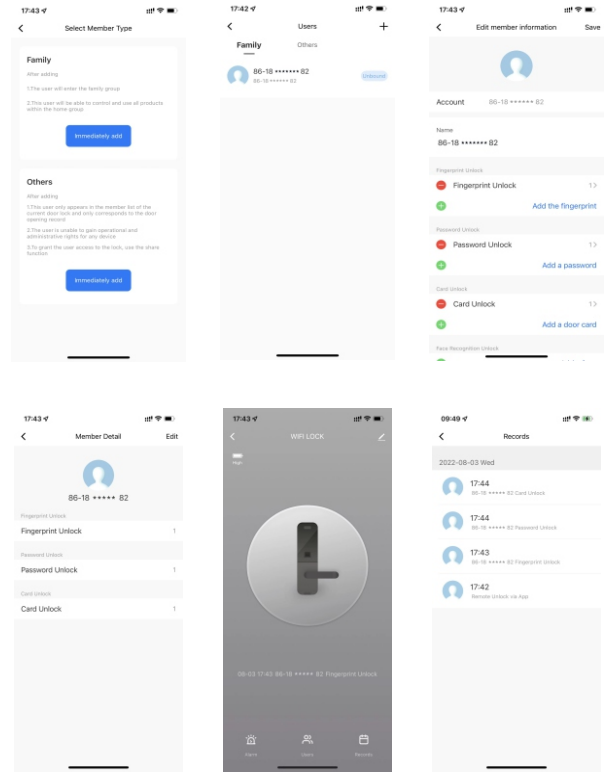

**Thank you for purchasing this product!**

Please keep this manual properly for future use, and the instructions are subject to change without notice.

Please read it carefully before use. The company shall not be responsible for accidents or damages caused by wrong operation.

